

Designed In Egypt

Tahta furniture cluster

Set of Dining table and side board with mirror

Project Name :

DE25_KA_Dining Set

Target Audience :

1- Consumers: citizens living in Upper Egypt (from Asyut to Luxor) with moderate to high income. Age from 25 to 40. This customer usually buys from Cairo because the available furniture in Sohag is not matching their taste and quality requirements.

2- Traders: this project targets wholesalers and furniture showrooms in Cairo. This customer needs new suppliers for the items they already have. New designs will be a plus. Good quality and suitable designs with reasonable prices are a must.

Problem Definition :

This design project is part of a bigger project for developing furniture cluster in Tahta to increase their productivity hence increasing the average income per person. To do this, new developed products need to be introduced to the cluster taking into consideration the capabilities of production, the clients' needs and the sales channels available.

Concept :

False door in ancient Egyptian culture

In Ancient Egypt, the false door was thought to be a threshold between the world of mortals and that of deities; where spirits lived. The deity could interact with the world of the living either by passing through the false door or receiving offerings through.

Concept of the name : KA

KA means the soul in ancient Egyptian culture , which is related to the concept of false door.



Mood Board :

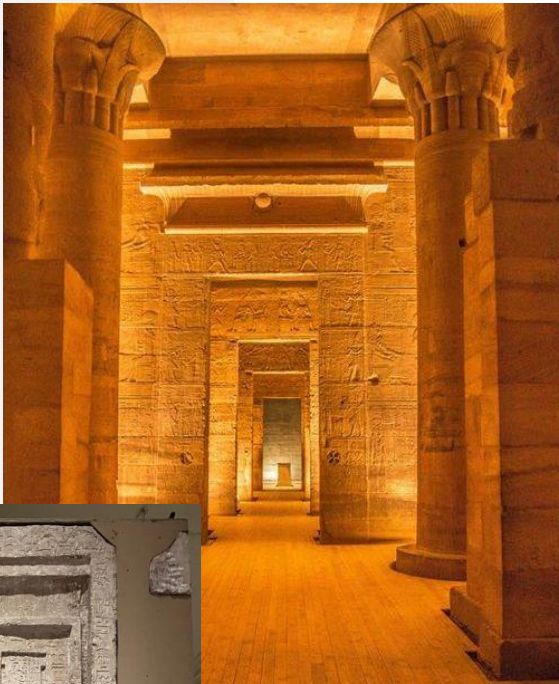

Old Kingdom (2649-2134 BC)

Gateways to eternity: the false door

A false door is a conventional representation of a door, usually of stone or wood. It represents a symbolic passage between the world of the living and that of the dead and became common from the 3rd Dynasty. The semi-cylindrical moulding at the centre represented a rolled-up reed mat which usually hung on the threshold of real doors. Through it the spirit (ka) of the deceased could enter and exit the other world and receive offerings placed by his family on the offering table. False doors were placed on the west wall of the offering chamber, at the back of the tomb.

العناصر الأساسية للباب الوهمي
رسمه سحرى فايفر

Standard elements of a false door.
Illustrated by Cindrella Fayez.

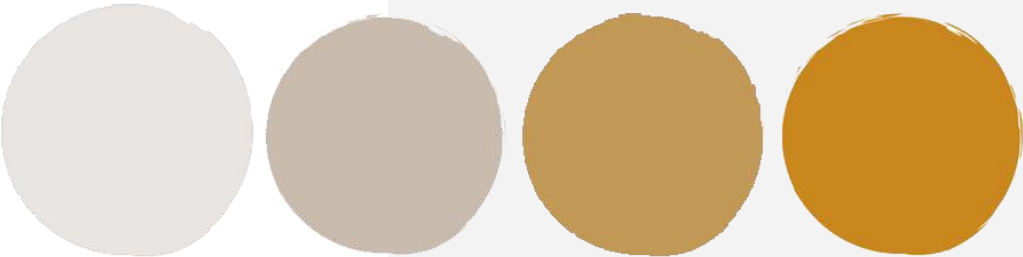

Design Process :

The ratio of false door has been achieved in the design



Final sketch for the design

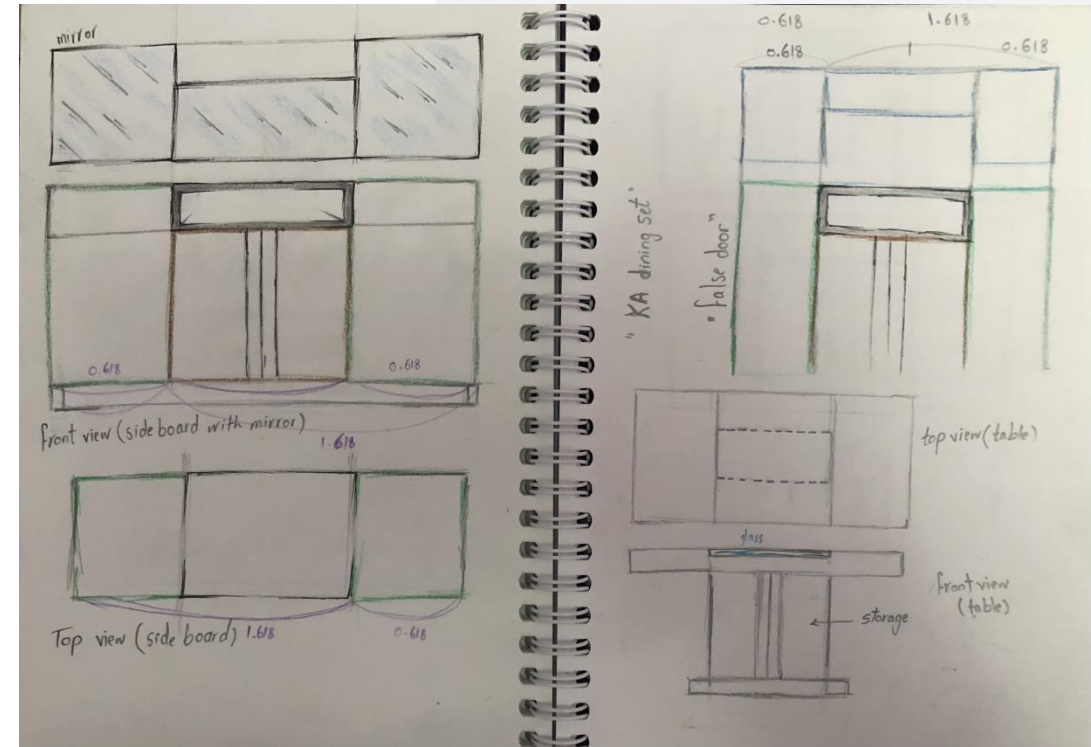

Design Process :

Some sketches until reaching the final sketch

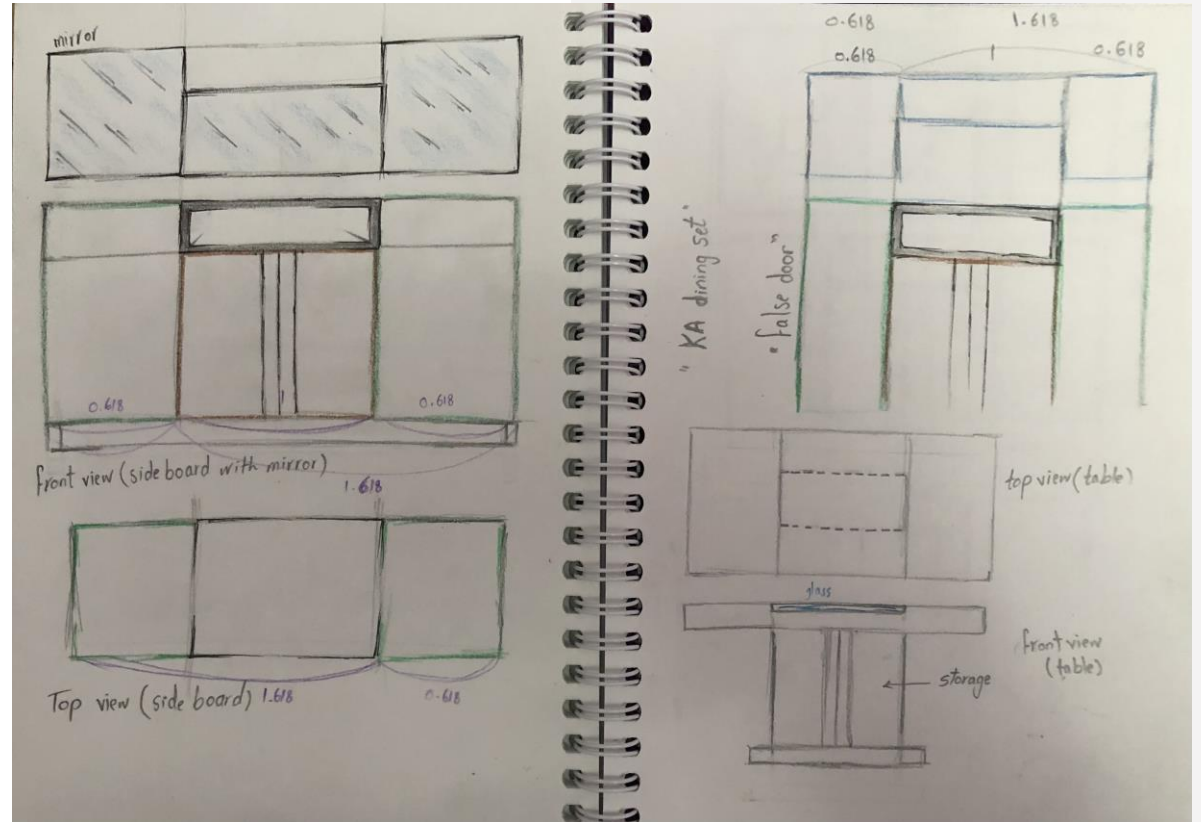
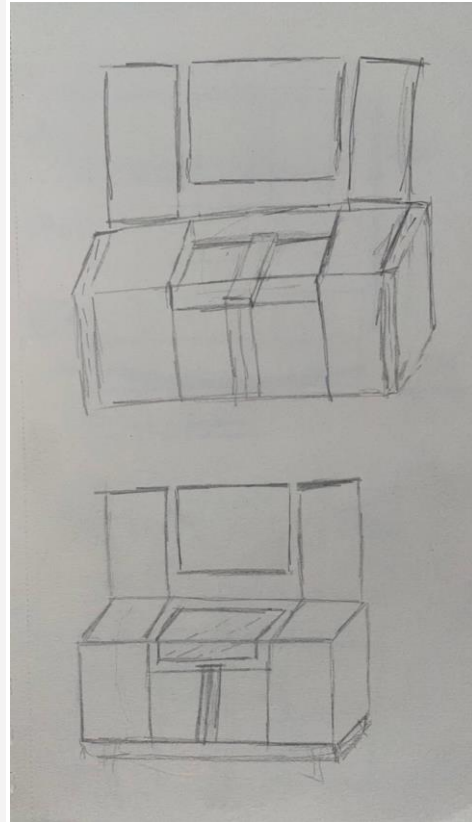
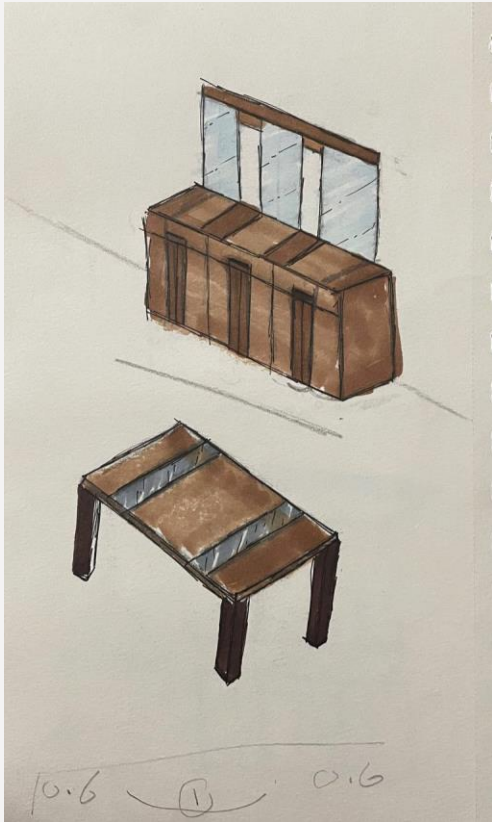

Material Board :

All names and codes of wood that used in the design from E EGGER Company



Melamine faced MDF boards 22mm - 18 mm - 6 mm
White wood
H1122 ST22



Melamine faced MDF boards 18 mm - 6 mm
Sand Gladstone Oak
H3309 ST28



Mirror

Connectors :

Mini fix

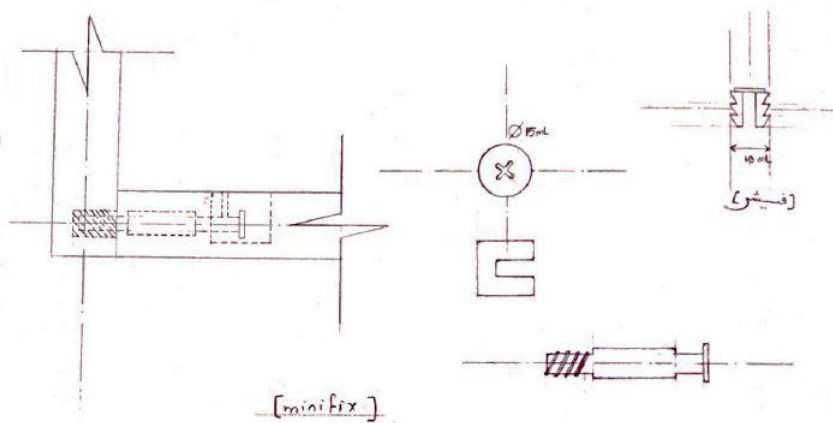

Hinges

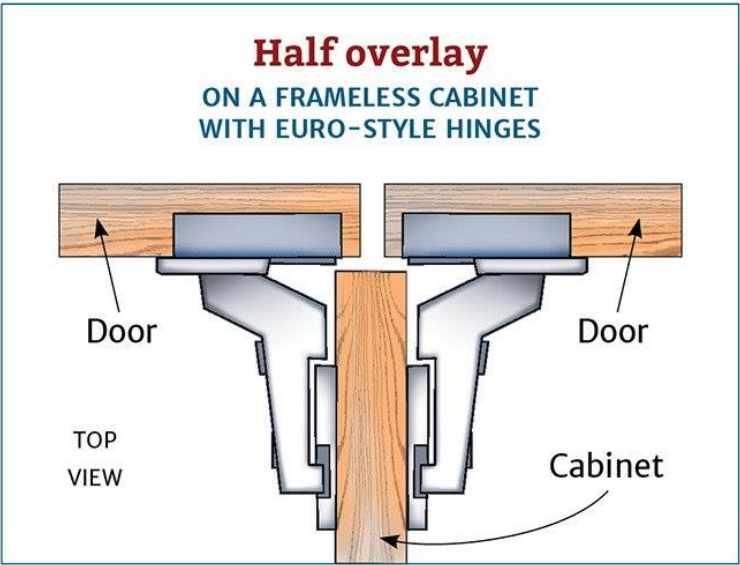
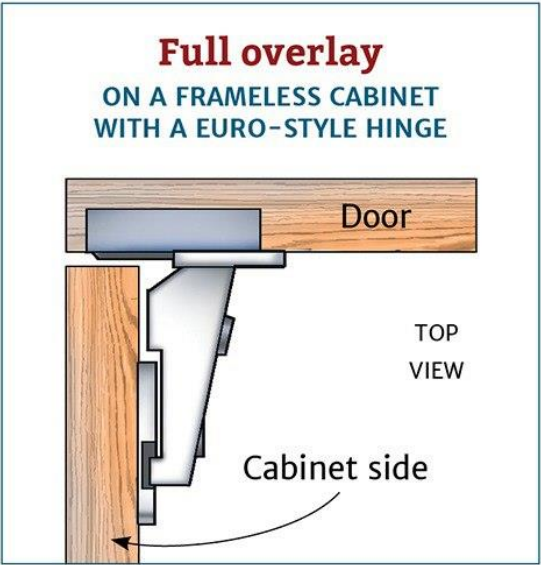

Details of drawers

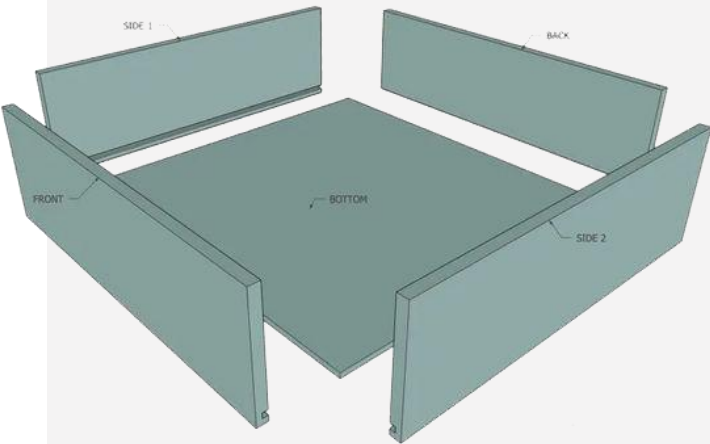
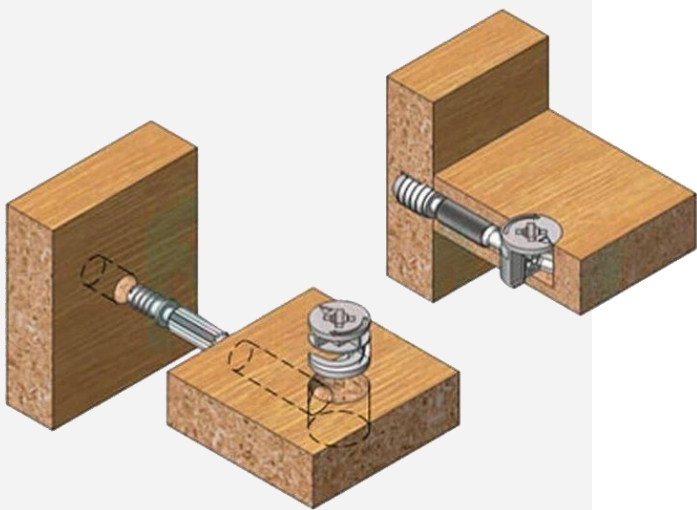

3d Rendered Shots :



3d Rendered Shots :



3d Rendered Shots :



3d Rendered Shots :

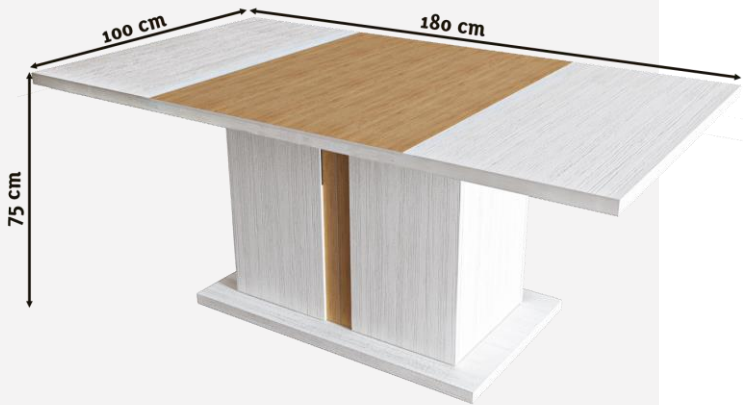

Workshop Drawings :

Workshop Drawings – Side board :

Natural lancaster Oak
H3368 ST9
Melamine faced MDF

All unit
White wood
H1122 ST22
Melamine faced MDF

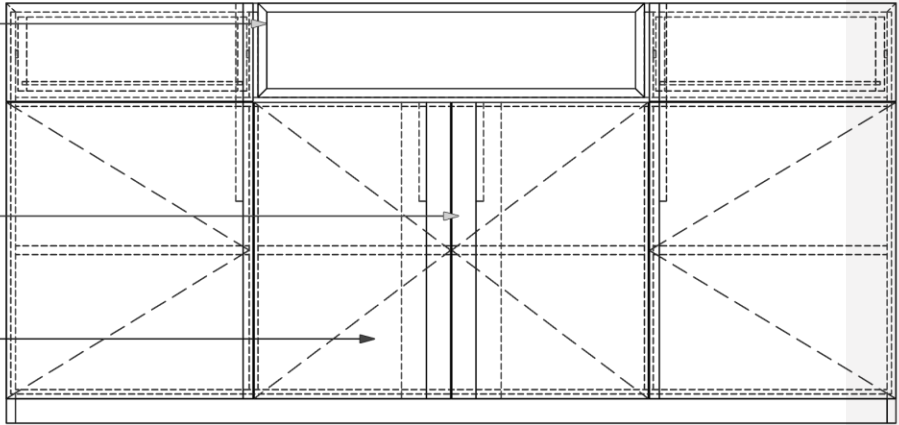
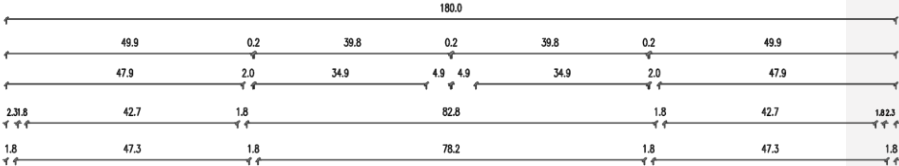
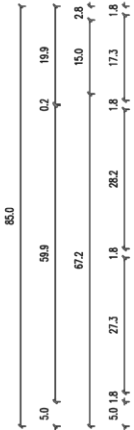

Front View

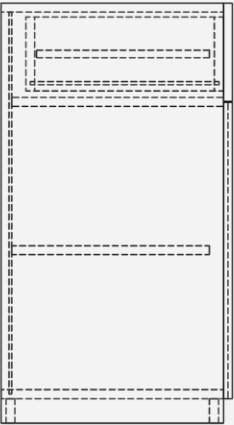
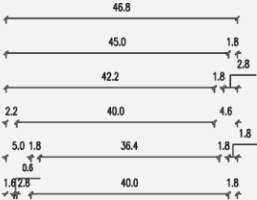

Side View

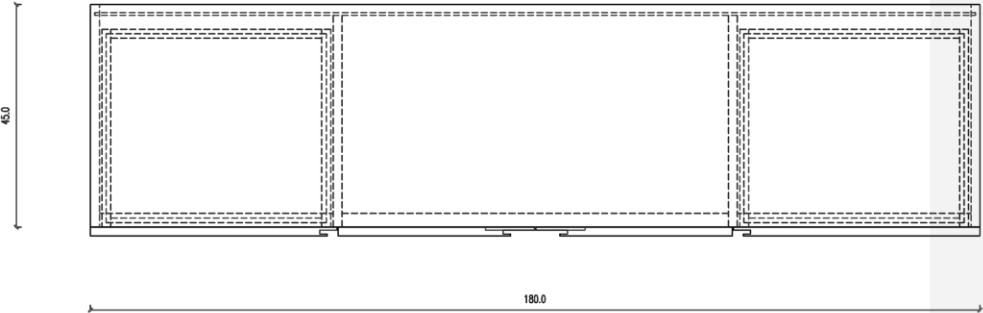

Top View

Workshop Drawings :

Workshop Drawings – Side board Mirror :

Natural lancaster Oak
H3368 ST9
Melamine faced MDF

Mirror

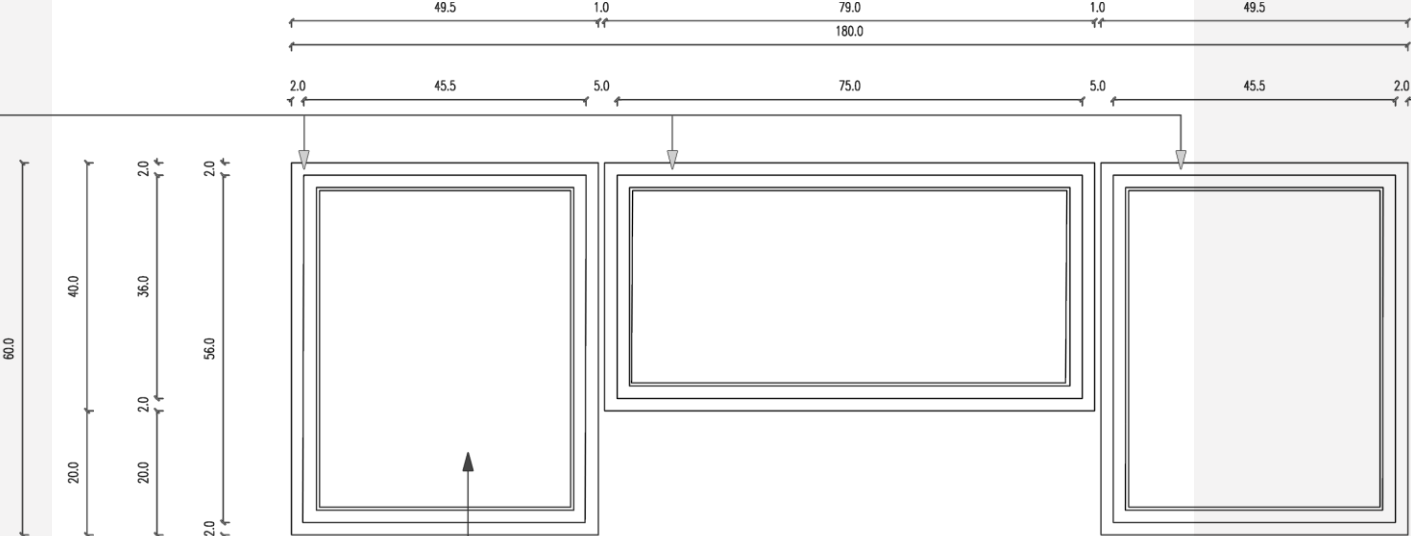

Front View



Top View



Side View

Workshop Drawings :

Workshop Drawings – Table with storage :

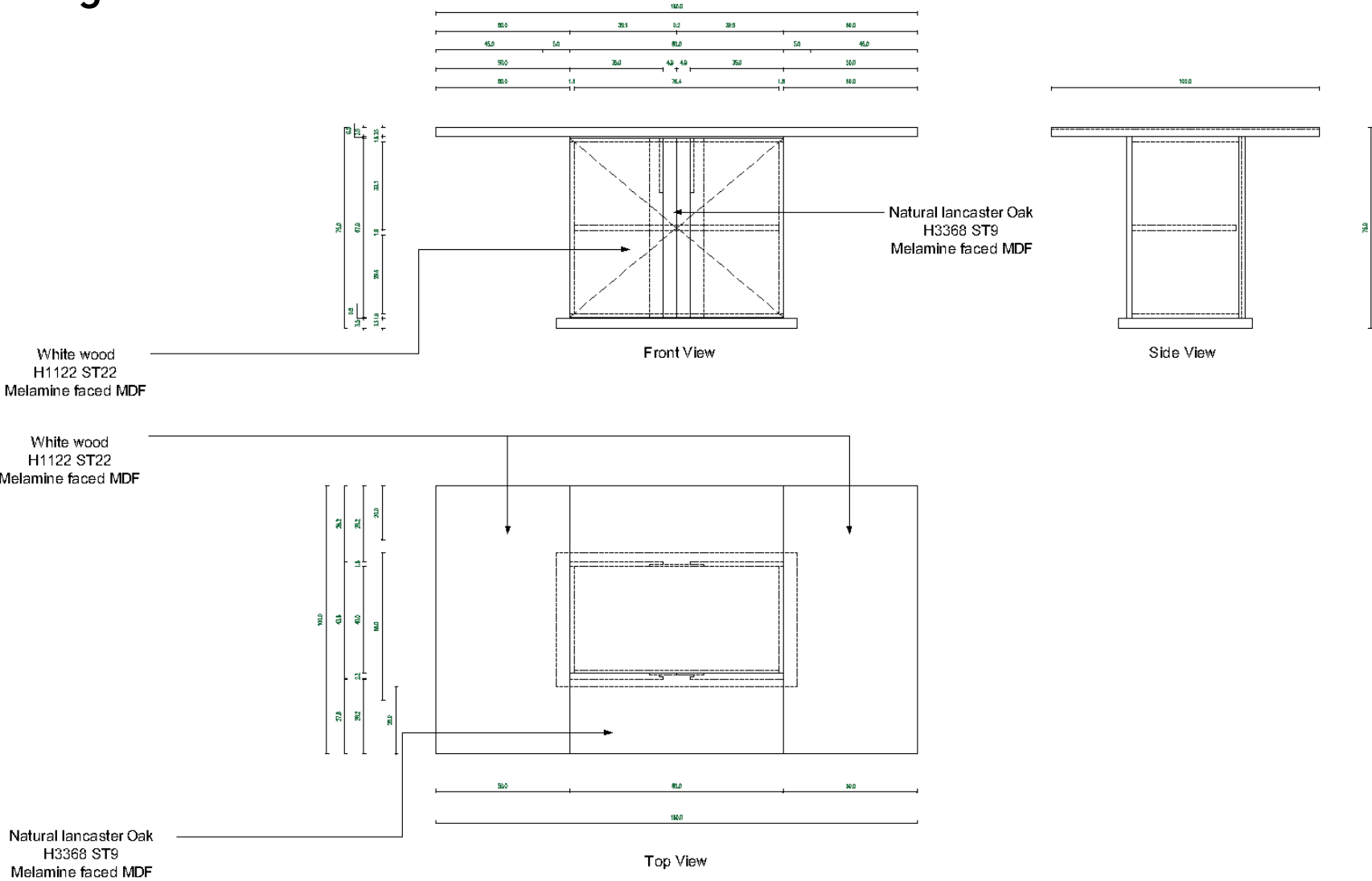

Cutting List :

Side Board Mirror						
اللون	العرض	الطول	التخانة	العدد	اسم القطعة	
Sand Gladstone Oak	49.5	60	1.8	2	إطار امرأة (1)	20
Sand Gladstone Oak	79	40	1.8	1	إطار المرأة (2)	21

Dinning Table						
اللون	العرض	الطول	التخانة	العدد	اسم القطعة	
White Wood	50	100	1.8	2	قرصة جانبية	22
White Wood	100	180	1.8	1	قرصة كاملة	23
White Wood	60	100	1.8	2	قاعدة	24
White Wood	40	80	1.8	2	قاعدة و برنيطة وحدة التخزين	25
White Wood	40	64.4	1.8	2	جنب	26
White Wood	39	76.4	1.8	1	رف	27
White Wood	35	68	1.8	2	ظهر (1)	28
Sand Gladstone Oak	80	100	1.8	1	قرصة وسطية	29
White Wood	35	68	2.2	2	دلف	30
Sand Gladstone Oak	10	68	0.6	2	مقبض	31
Sand Gladstone Oak	20	68	0.6	1	ظهر (2)	32

Side Board						
اللون	العرض	الطول	التخانة	العدد	اسم القطعة	
White Wood	5	176.4	1.8	2	سكوا	1
White Wood	45	85	1.8	2	جنب	2
White Wood	45	176.4	1.8	1	قاعدة	3
White Wood	42.8	176.4	1.8	1	قاطوع أفقي	4
White Wood	42.8	57.3	1.8	2	قاطوع رأسي (1)	5
White Wood	42.8	17.3	1.8	2	قاطوع رأسي (2)	6
White Wood	45	50.9	1.8	2	قرصة جانبية	7
White Wood	40	47.3	1.8	2	رف (1)	8
White Wood	40	78.2	1.8	1	رف (2)	9
White Wood	15	40	1.8	4	جنب علبة الدرج	10
White Wood	15	42.7	1.8	4	وش و ظهر علبة الدرج	11
Sand Gladstone Oak	45	78.2	1.8	2	قرصة وسطية و قاعدتها	12
Sand Gladstone Oak	19.1	42.8	1.8	2	قاطوع رأسي (3)	13
White Wood	49.9	19.9	2.2	2	وش الدرج	14
White Wood	49.9	59.9	2.2	2	دلف (1)	15
White Wood	34.9	59.9	2.2	2	دلف (2)	16
White Wood	77.3	178.2	0.6	1	ظهر	17
White Wood	38.2	44.6	0.6	2	قاعدة الدرج	18
Sand Gladstone Oak	10	59.9	0.6	2	مقبض	19

Cutting Plan :

Melamine faced MDF boards 18 mm
White wood
H1122 ST22



1

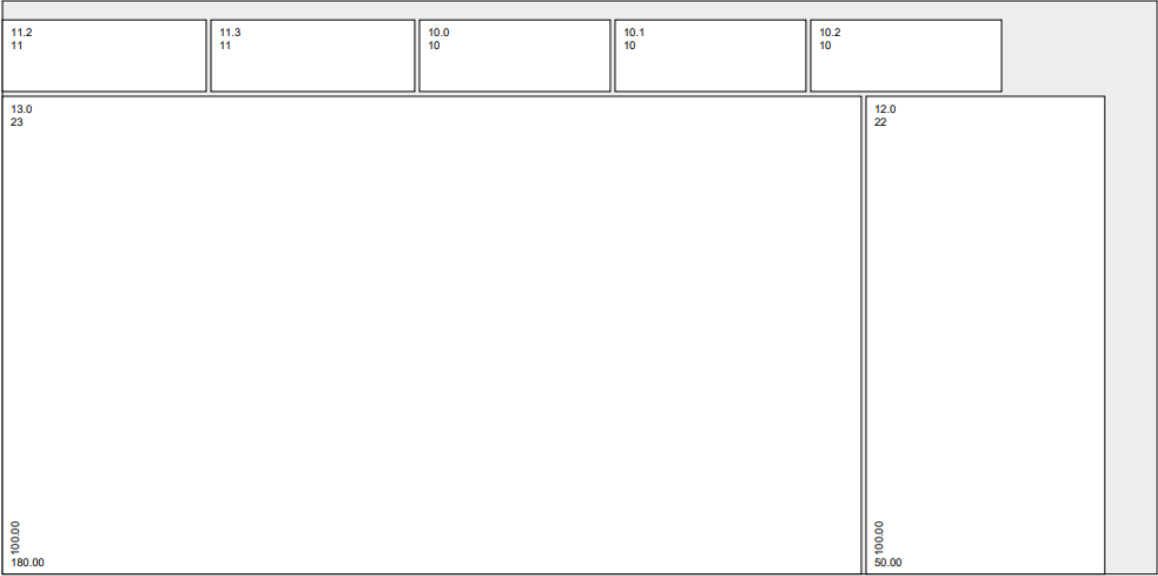

2

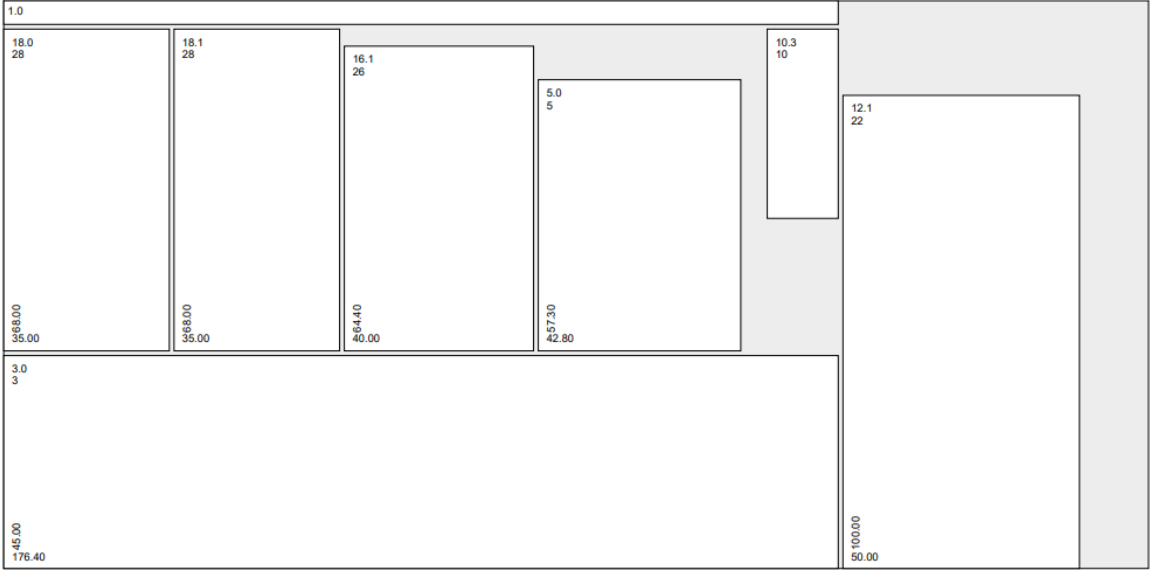

3

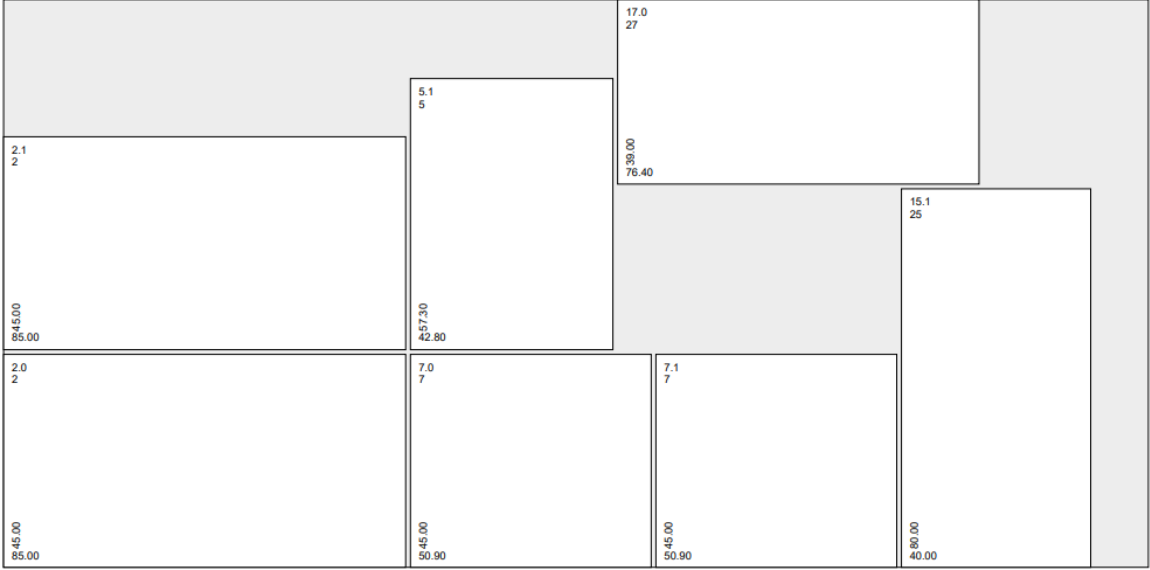

4



5

Cutting Plan :

Melamine faced MDF boards 22 mm
White wood
H1122 ST22

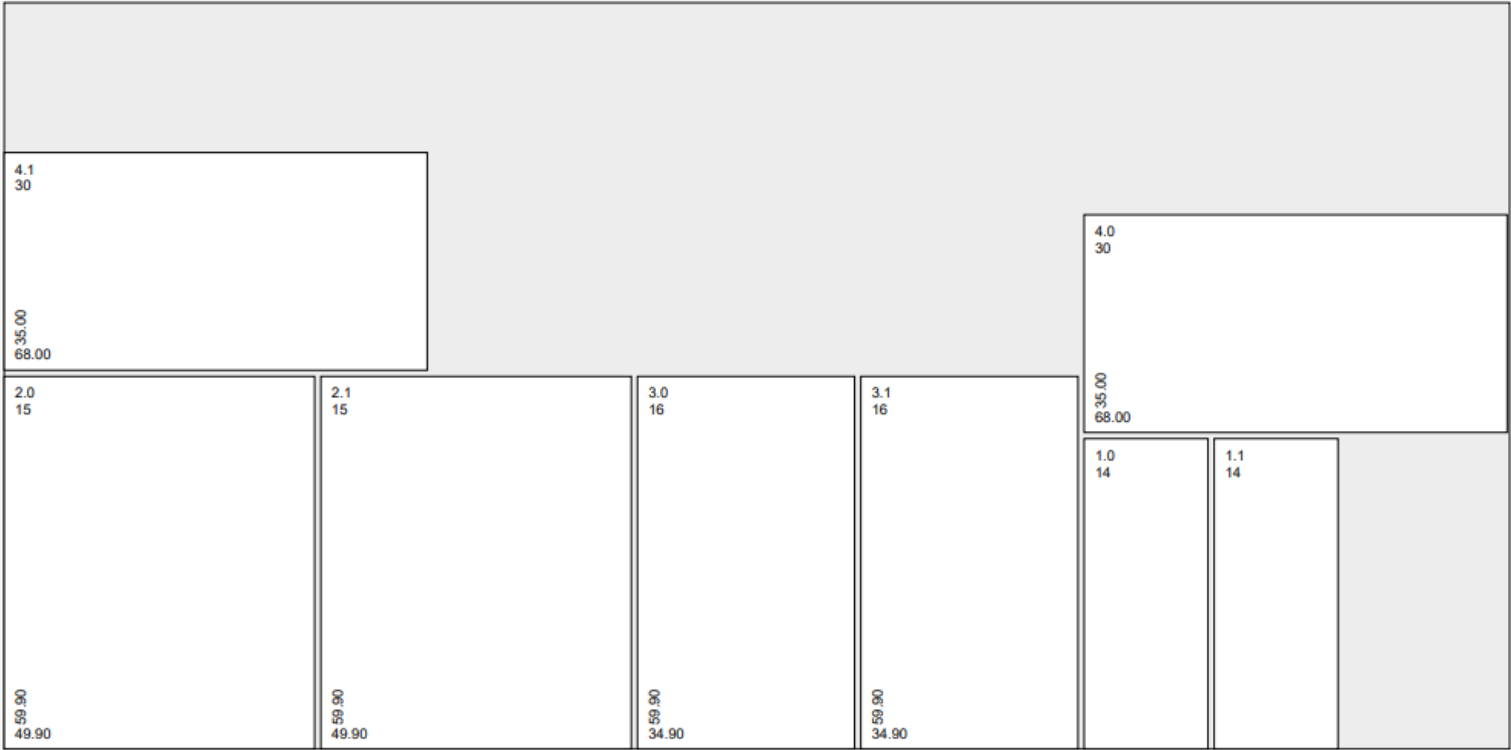

Cutting Plan :

Melamine faced MDF boards 6 mm
White wood
H1122 ST22



Cutting Plan :

Melamine faced MDF boards 18 mm
Sand Gladstone Oak
H3309 ST28

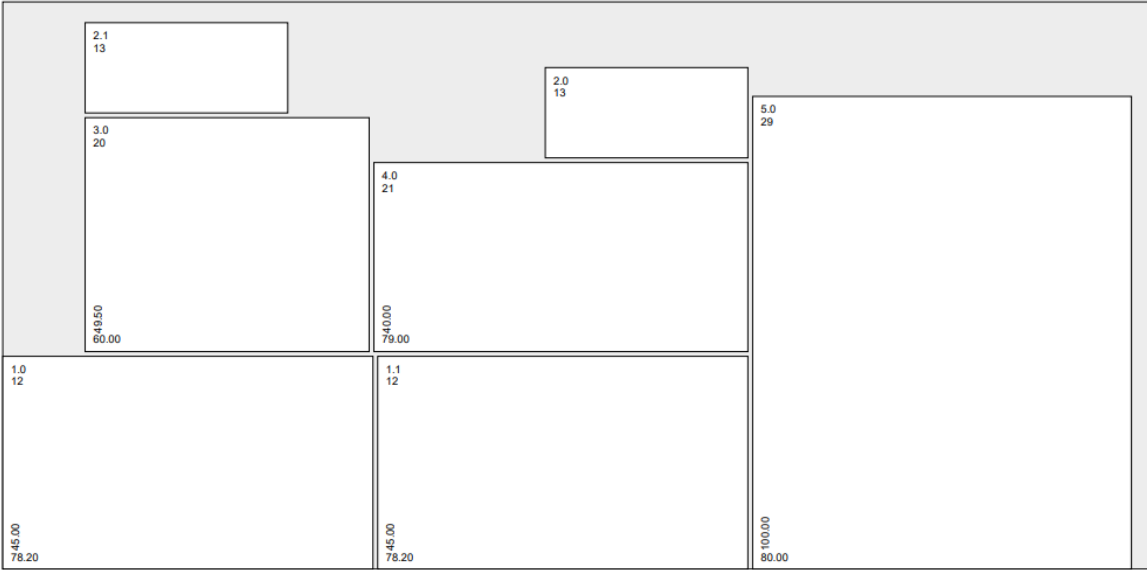

1

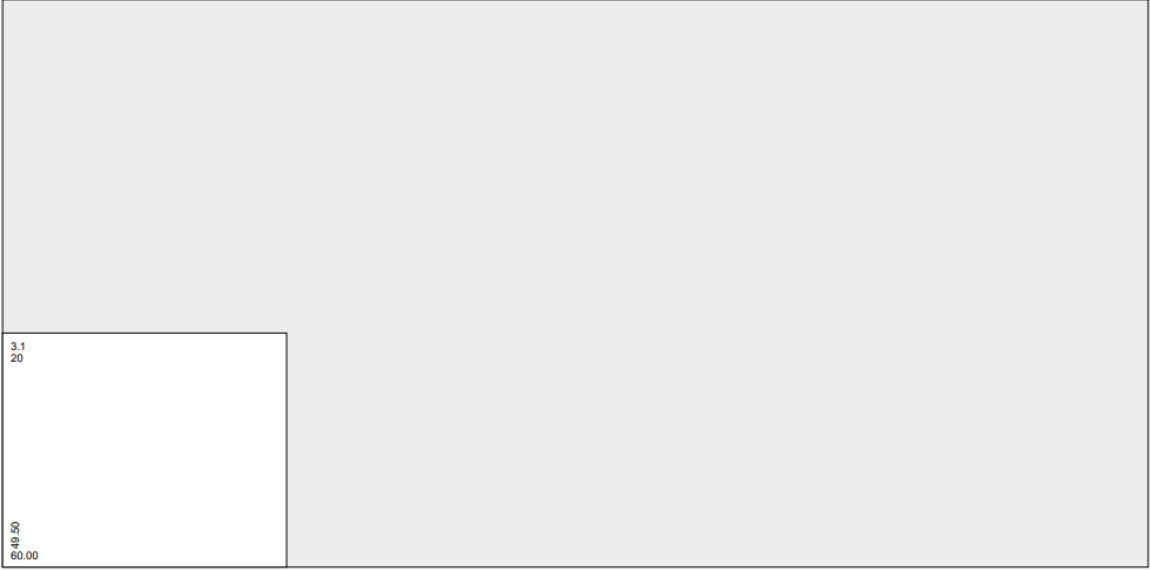

2

Cutting Plan :

Melamine faced MDF boards 6 mm
Sand Gladstone Oak
H3309 ST28

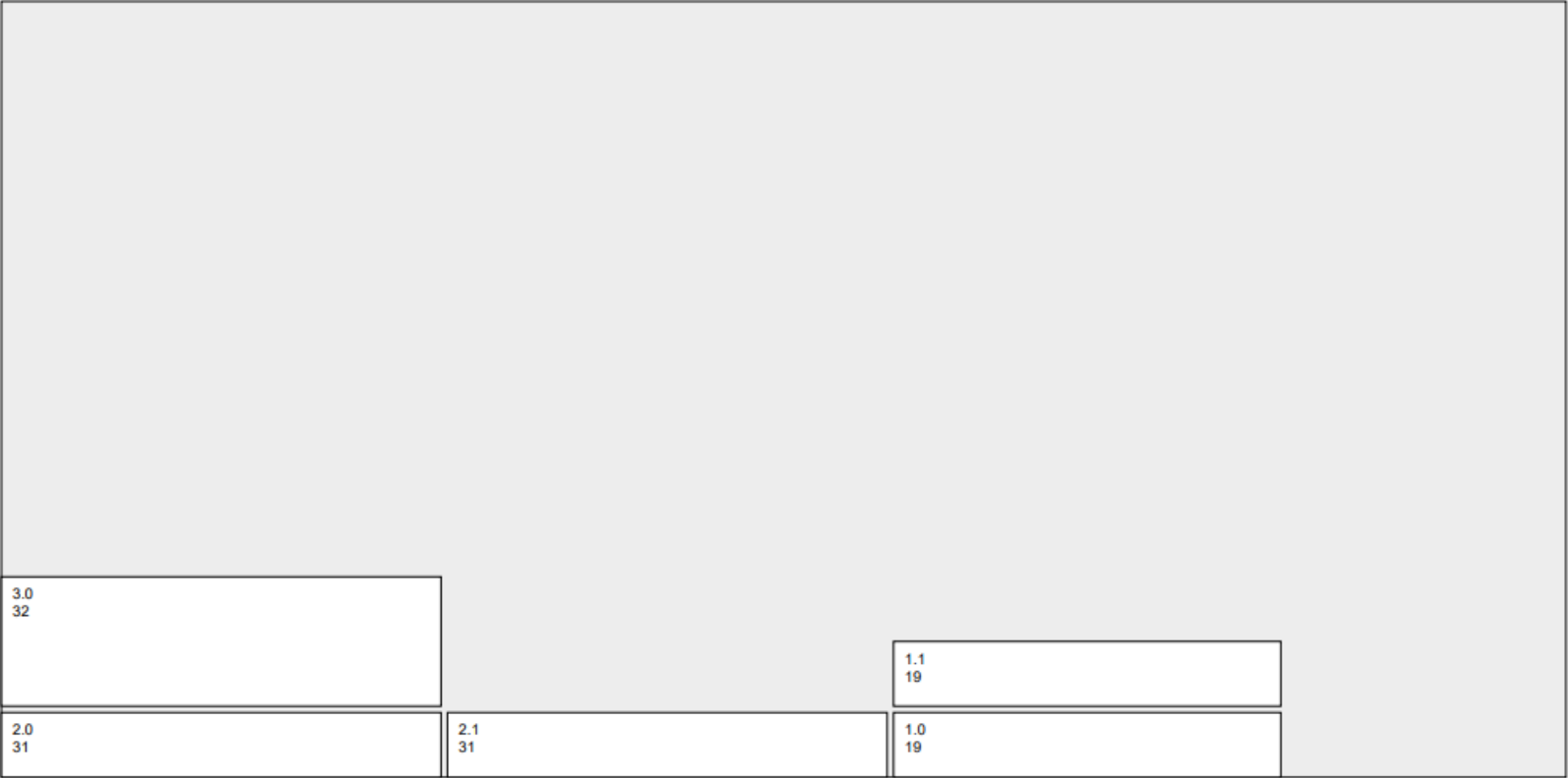

KADAWIT

DINING SET

- **Bawit** Chair
- **KA** Dining Table, Buffet



Dining *Table*



Components

Side *Table*



Dining *Chair*

PARTICIPANTS :



Shrouq Emad Saad
shrouqemad11@gmail.com
01023909468



Rawan Ahmed Mohamed
Rawan.ahmed601@gmail.com
01275544572